

CM1882-W HARMONY™

US Patent pending



2' x 2' General Use

US Patent D1,065,646

VisaLighting.com/products/Harmony

Type: _____ Project: _____ Location: _____

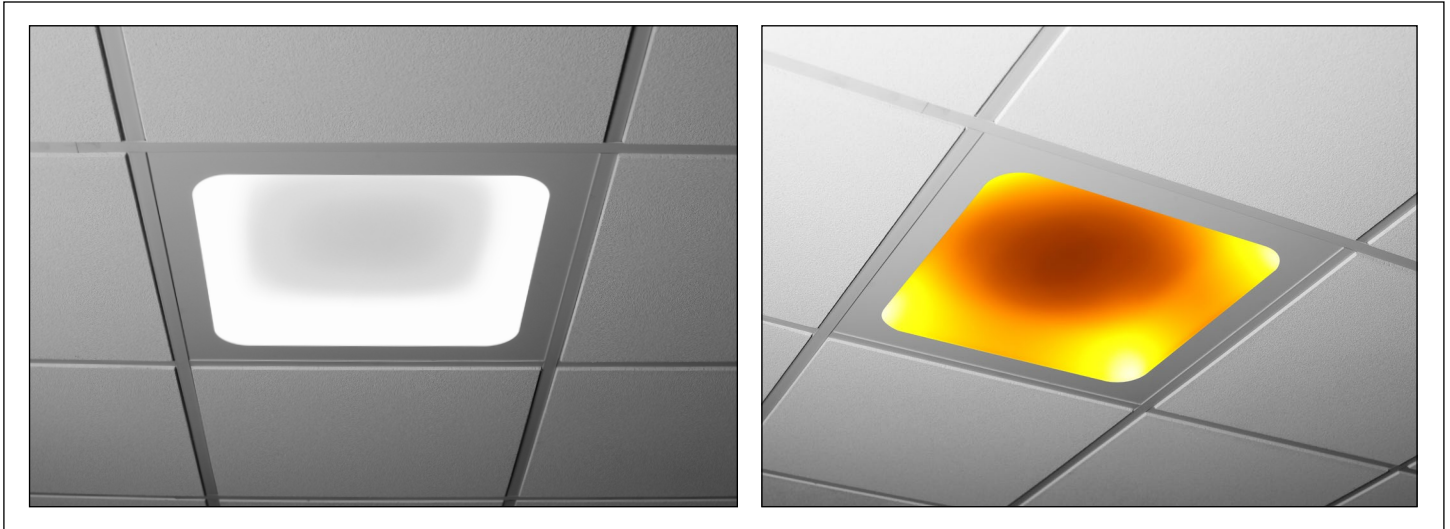

DIMENSIONS

W = Width L = Length WT = Weight

W	23-3/4" (603 mm)
L	23-3/4" (603 mm)
WT (Housing)	22 lbs (9979 gm)
WT (Driver Box)	< 2.5 lbs (<1134 gm)

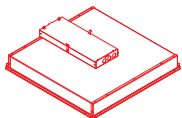
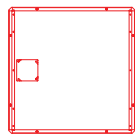
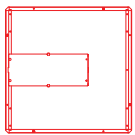
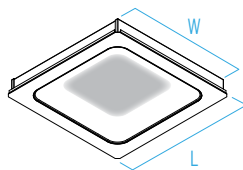
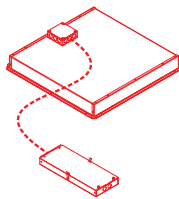
Top Mounted Driver (TMD)**Remote Mounted Driver (RMD)**

RELATIVE SCALE DRAWING

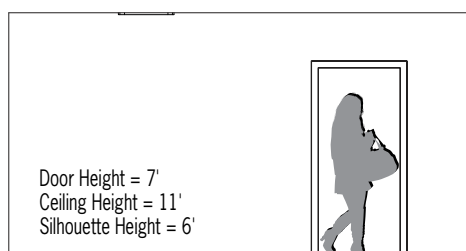

FEATURES

- BAA (Buy American Act) and BABA (Build American, Buy America) compliant
- High, medium, and low lumen output options
- Drivers conveniently mounted in a separate box. Mounted on top of unit [Top Mounted Driver (TMD) option] or mounted remotely [Remote Mounted Driver (RMD) option]
- Shallow recessed depth (2-7/8") minimizes interference with systems within ceiling plenum, Chicago Plenum certified (CP option)
- Suitable for installation on most standard 2x2 T-bar grid systems
- Accessory Kit (SRI-2x2) for drywall/sheetrock installations available (order separately – see page 4)
- Diffuser: one piece vacuum formed high transmittance matte white acrylic
- Housing: 14-gauge aluminum body coated in high-reflectance white paint
- Front Bezel: one piece 14-gauge aluminum powder coated in matte white
- Finish: all powder-coated surfaces utilize antimicrobial paint (no VOC)
- Suitable for restricted air flow applications. See [Installation Instructions](#) for more information
- ETL listed for wet locations. Not suitable for exterior applications
- Room side of unit is Certified NSF2 Splash/Non-Food Zone
- Room side of unit is Certified IP64

PHOTOMETRICS

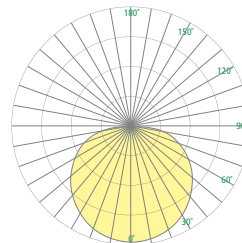

CM1882-W HARMONY™ (cont.)

2' x 2' General Use



EXAMPLE: CM1882-W-L35K(H)-MVOLT-TMD-CP

CM1882-W				
MODEL	SOURCE ¹	CIRCUITS-VOLTAGE	DRIVER BOX	OPTION
CM1882-W	<ul style="list-style-type: none"> • L30K(H) • L30K(M) • L30K(L) • L35K(H) • L35K(M) • L35K(L) • L40K(H) • L40K(M) • L40K(L) 	MVOLT	RMD Remote Mounted Driver TMD Top Mounted Driver	CP Chicago Plenum

SOURCE¹ (Select one)

Dimmable 0-10V to 1%, Minimum 90CRI, within 3-step MacAdam

Source	CCT	Delivered Lumens	Power (Watts)
L30K(H)	3000K	3500	52
L30K(M)	3000K	2600	38
L30K(L)	3000K	1700	25
L35K(H)	3500K	3600	52
L35K(M)	3500K	2700	38
L35K(L)	3500K	1800	25
L40K(H)	4000K	3600	52
L40K(M)	4000K	2700	38
L40K(L)	4000K	1800	25

LUMEN MAINTENANCE RATING

L85 (reported)	>60,000 hrs
----------------	-------------

Reported Lifetime per IES TM-21

CM1882-W HARMONY™ (cont.)

2' x 2' General Use

US Patent D1,065,646



REMOTE DRIVER

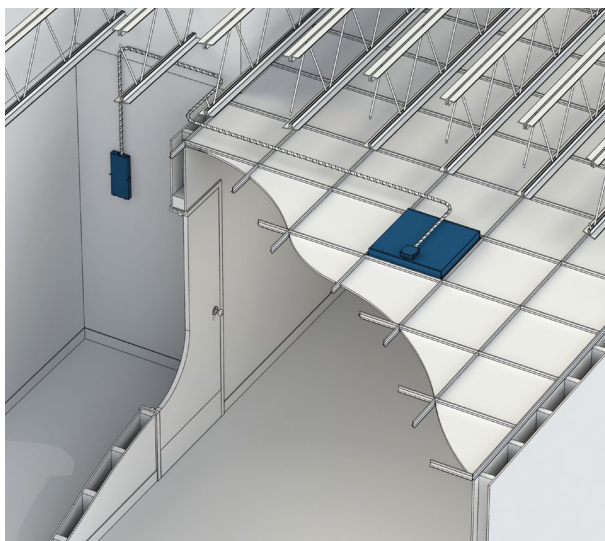

The slim Remote Driver (**RMD**) compartment can be mounted in remote locations such as corridors and wiring closets on the floor or wing of the facility using low voltage wiring. **RMD** is recommended for Sheet Rock/Drywall installations for easy driver maintenance.

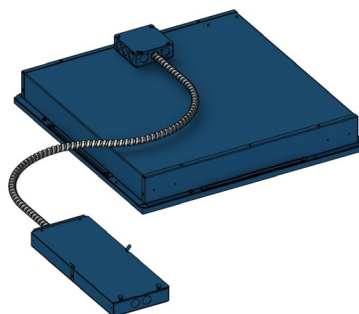

Maximum Recommended
Remote Wiring
Distance from Remote
Driver to Fixture Connection

	2C	3C
10AWG	375 ft	325 ft
12AWG	250 ft	200 ft
14AWG	150 ft	125 ft
16AWG	75 ft	75 ft
18AWG	50 ft	50 ft
20AWG	25 ft	25 ft

Top mounted 4x4 J-box included with remote driver
Wiring between remote box and fixture by others

TOP MOUNTED DRIVER (TMD)

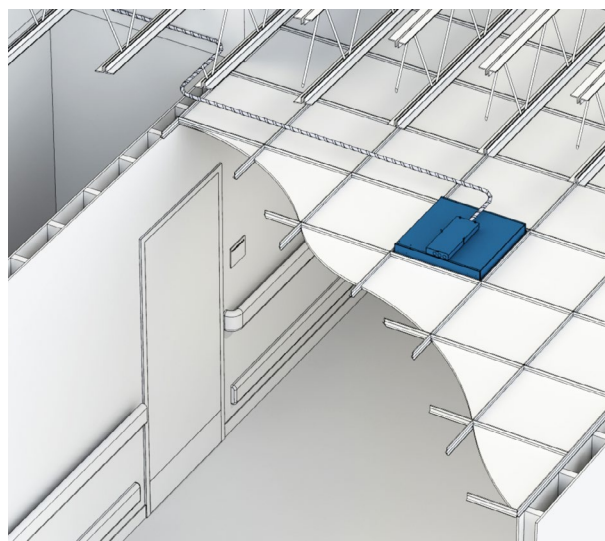

If corridor plenums are overcrowded, the driver can be mounted within the patient room ceiling utilizing the Top Mounted Driver option (**TMD**). Driver compartment can be accessed via adjacent ceiling tile

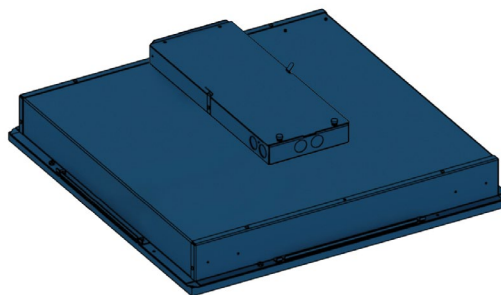

REMOTE DRIVER BOX INFORMATION

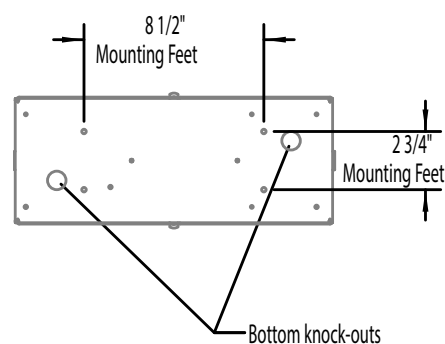
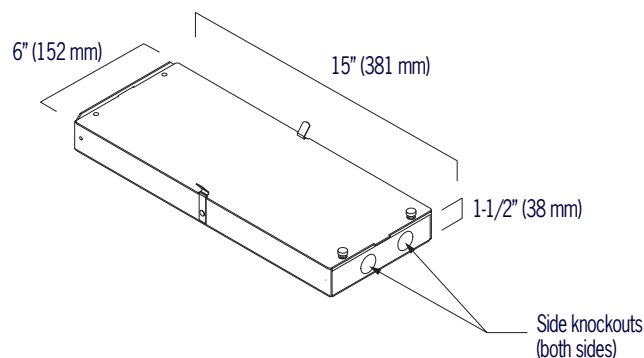

CM1882-W HARMONY™ (cont.)

2' x 2' General Use



GRID MOUNTING

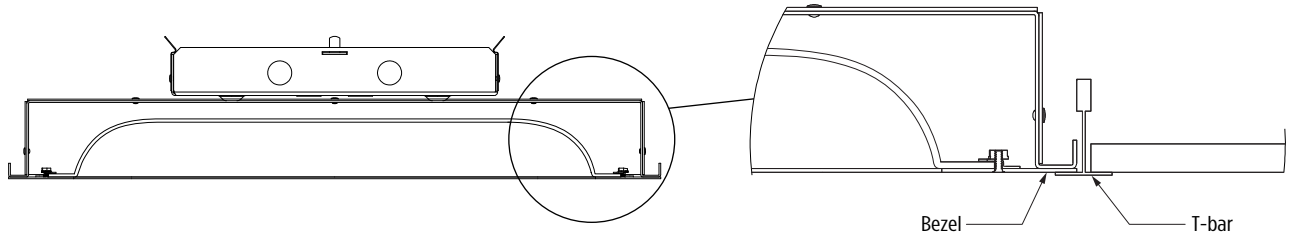

SRI-2x2 Sheetrock Installation Kit (Order Separately)

SRI-2x2 flange covers gap between ceiling board and light fixture. Suspend kit from structure. Insert fixture into ceiling and rest on flange. See [Installation Instructions](#) for dimensions. Remote Driver (RMD) Option is recommended for easy driver maintenance in sheetrock/drywall installations

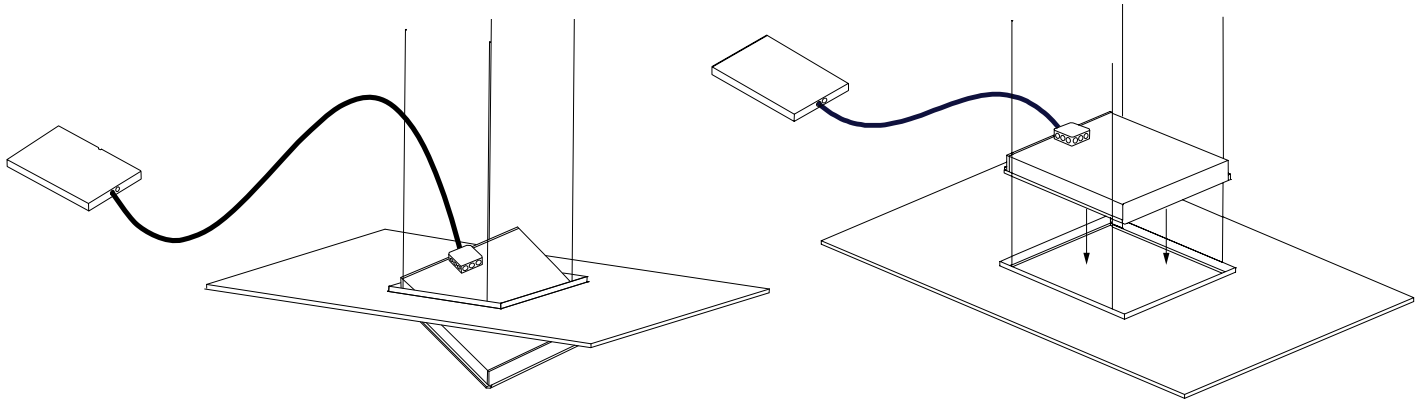

HARMONY PRODUCT FAMILY

General Use	2'x2'	• CM1882-W
	2'x4'	• CM1886-W
General Use Tunable	2'x2'	• CM1882-T
	2'x4'	• CM1886-T
Overbed	2'x2'	• CM1881-W
	2'x4'	• CM1885-W
High Abuse/ Behavioral Health Overbed	2'x2'	• CM1883-W
	2'x4'	• CM1887-W
High Abuse/ Behavioral Health General Use	2'x2'	• CM1884-W
	2'x4'	• CM1888-W
High Abuse/ Behavioral Health General Use Tunable	2'x2'	• CM1884-T
	2'x4'	• CM1888-T

SUGGESTED VARIATIONS

- Alternate dimming control compatibility
- Custom colors for lens frame
- Custom light output

See [VisaLighting.com/products/Harmony](https://www.VisaLighting.com/products/Harmony) for more information