

CM1884-W HARMONY™

US Patent pending

2' x 2' Behavioral & Mental Health, General Use

US Patent D1,065,646

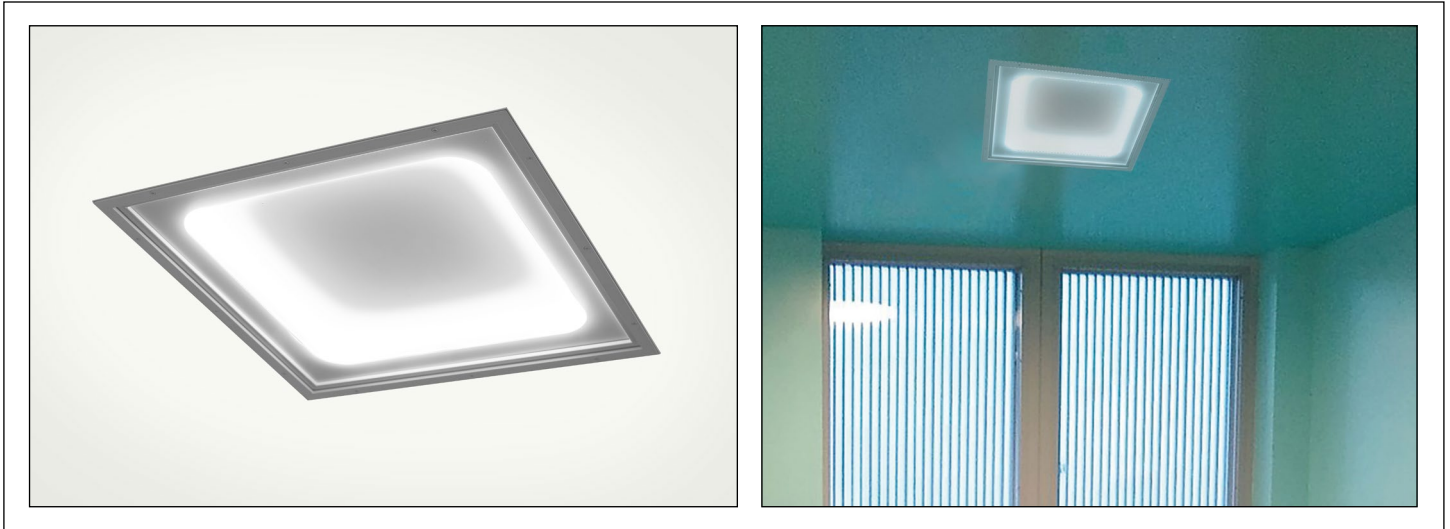

VisaLighting.com/products/Harmony

Type: _____ Project: _____ Location: _____

**DIMENSIONS**

W = Width L = Length WT = Weight

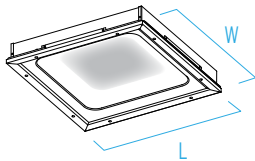
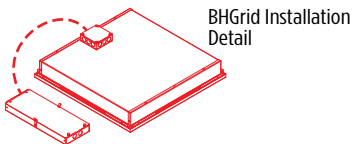
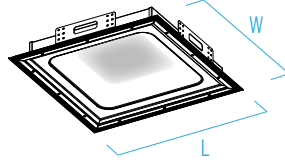
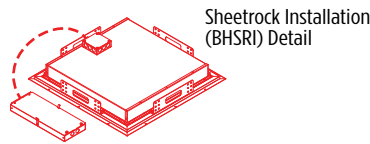
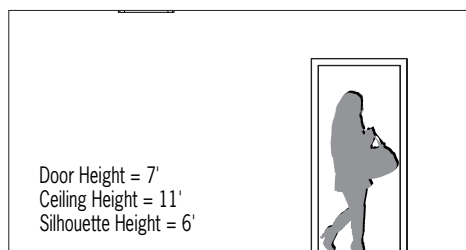
	Grid Install	SRI Install
W	23-3/4" (603 mm)	27-1/2" (700 mm)
L	23-3/4" (603 mm)	27-1/2" (700 mm)
WT (Housing)	22 lbs (9979 gm)	
WT (Driver Box)	< 2.5 lbs (<1134 gm)	

BHGrid Installation**BHSRI Installation****BHGrid Installation Detail****Sheetrock Installation (BHSRI) Detail****RELATIVE SCALE DRAWING****FEATURES**

- BAA (Buy American Act) and BABA (Build American, Buy America) compliant
- High, medium and low lumen output options
- Impact tests performed exceed IK10+ rating over multiple impacts and include ligature resistance testing after each impact
- High abuse lens and frame features 3/16" thick, high impact clear polycarbonate with anti-scratch coating secured with tamper resistant fasteners
- Ligature resistant; sheetrock/drywall installation (see [Installation Instructions](#)), not suited for grid ceiling installation
- Driver mounted in a separate enclosure; must be remote mounted (connection to fixture by others)
- Diffuser: one piece vacuum formed high transmittance matte white acrylic
- Housing: 14-gauge aluminum body coated in high-reflectance white paint
- Front Bezel: one piece 14-gauge aluminum powder coated in matte white
- Finish: all powder-coated surfaces utilize antimicrobial paint (no VOC)
- Room side of unit is Certified IP65, BHSRI(IP65) installation option only
- Suitable for restricted air flow applications. See [Installation Instructions](#) for more information
- ETL listed for damp locations. Not suitable for exterior applications

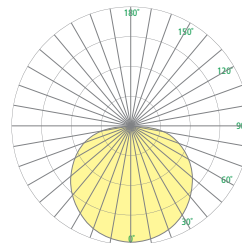
PHOTOMETRICS

Compliant



IP65 Certified



ETL Listed



5 Year Warranty

CM1884-W HARMONY (cont.)

2' x 2' Behavioral & Mental Health, General Use



EXAMPLE: CM1884-W-L35K(H)-MVOLT-90CRI-BHSRI

CM1884-W				
MODEL	SOURCE ¹	CIRCUITS-VOLTAGE	INSTALLATION	OPTION
CM1884-W	<ul style="list-style-type: none"> • L30K(H) • L30K(M) • L30K(L) • L35K(H) • L35K(M) • L35K(L) • L40K(H) • L40K(M) • L40K(L) 	MVOLT	BHSRI BH Casing for Hard Ceiling BHSRI(IP65) BH Casing for Hard Ceiling, IP65 BHGRID BH Casing for standard Plenum Ceiling	CP Chicago Plenum

SOURCE¹ (Select one)

Dimmable 0-10V to 1%, Minimum 90CRI, within 3-step MacAdam

Source	CCT	Delivered Lumens	Power (Watts)
L30K(H)	3000K	3500	52
L30K(M)	3000K	2600	38
L30K(L)	3000K	1700	25
L35K(H)	3500K	3600	52
L35K(M)	3500K	2700	38
L35K(L)	3500K	1800	25
L40K(H)	4000K	3600	52
L40K(M)	4000K	2700	38
L40K(L)	4000K	1800	25

LUMEN MAINTENANCE RATING

L85 (reported)	>60,000 hrs
----------------	-------------

Reported Lifetime per IES TM-21

CM1884-W HARMONY (cont.)

2' x 2' Behavioral & Mental Health, General Use

US Patent D1,065,646



REMOTE DRIVER

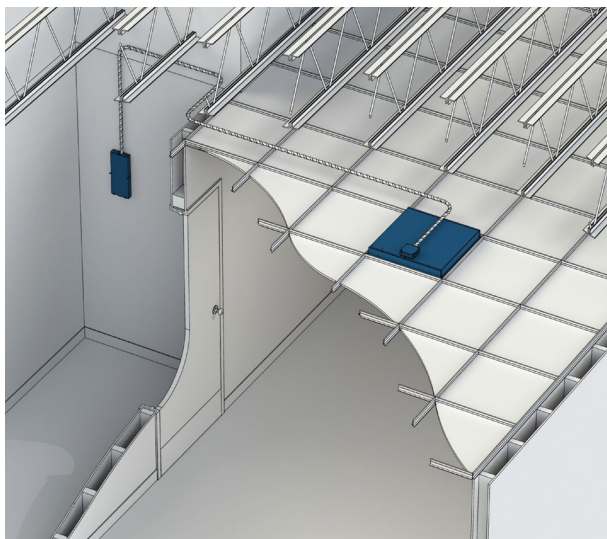

The slim Remote Driver compartment must be mounted in remote locations such as corridors and wiring closets on the floor or wing of the facility using low voltage wiring.

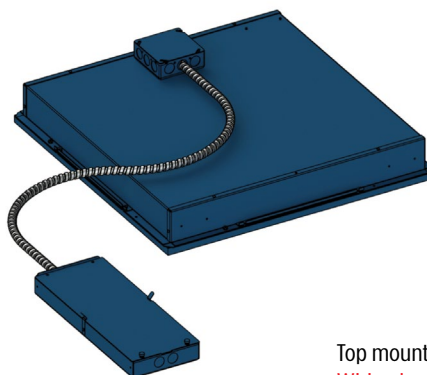

Maximum Recommended Remote Wiring Distance from Remote Driver to Fixture Connection

	2C	3C
10AWG	375 ft	325 ft
12AWG	250 ft	200 ft
14AWG	150 ft	125 ft
16AWG	75 ft	75 ft
18AWG	50 ft	50 ft
20AWG	25 ft	25 ft

Top mounted 4x4 J-box included with remote driver
Wiring by others

REMOTE DRIVER BOX INFORMATION

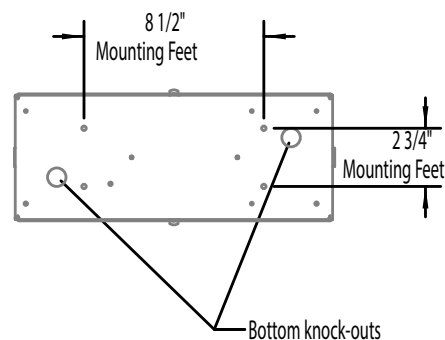
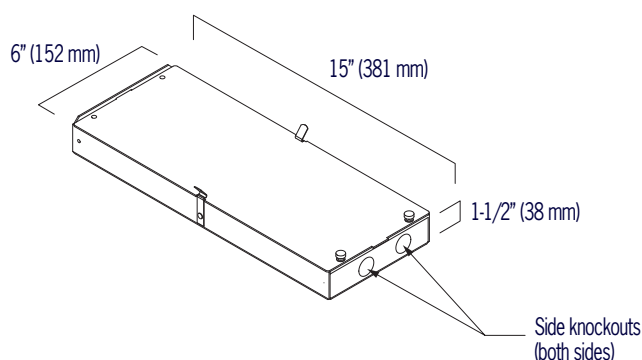

CM1884-W HARMONY (cont.)

2' x 2' Behavioral & Mental Health, General Use



INSTALLATION INFORMATION

Grid Installation BHGrid Detail

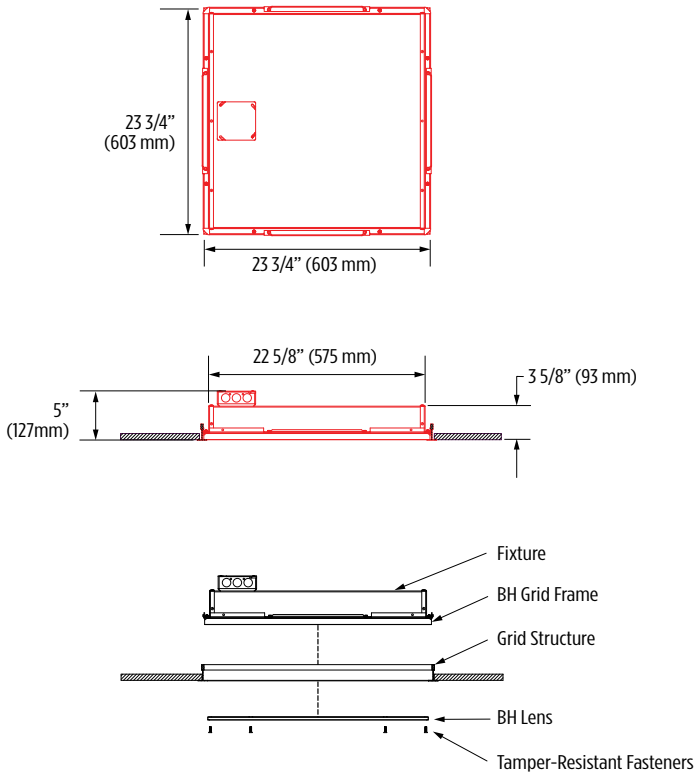

Sheetrock Installation BHSRI & BHSRI(IP65) Detail

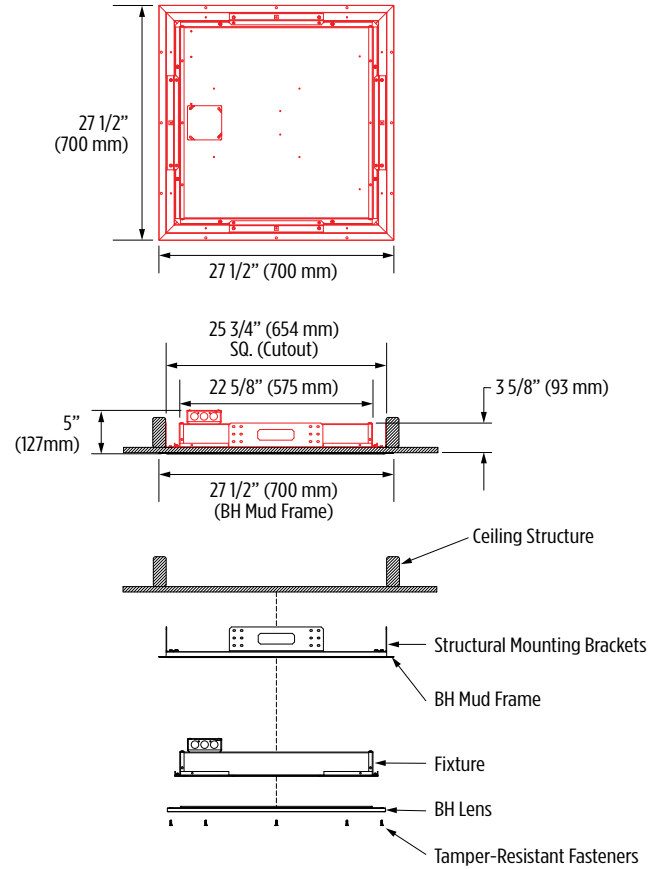

HARMONY PRODUCT FAMILY

General Use	2'x2'	• CM1882-W
	2'x4'	• CM1886-W
General Use Tunable	2'x2'	• CM1882-T
	2'x4'	• CM1886-T
Overbed	2'x2'	• CM1881-W
	2'x4'	• CM1885-W
High Abuse/ Behavioral Health Overbed	2'x2'	• CM1883-W
	2'x4'	• CM1887-W
High Abuse/ Behavioral Health General Use	2'x2'	• CM1884-W
	2'x4'	• CM1888-W
High Abuse/ Behavioral Health General Use Tunable	2'x2'	• CM1884-T
	2'x4'	• CM1888-T

SUGGESTED VARIATIONS

- Alternate dimming control compatibility
- Custom colors for lens frame
- Custom light output

See VisaLighting.com/products/Harmony for more information