

**CM1884-W HARMONY™**

US Patent pending

2' x 2' Behavioral &amp; Mental Health, General Use

US Patent D1,065,646

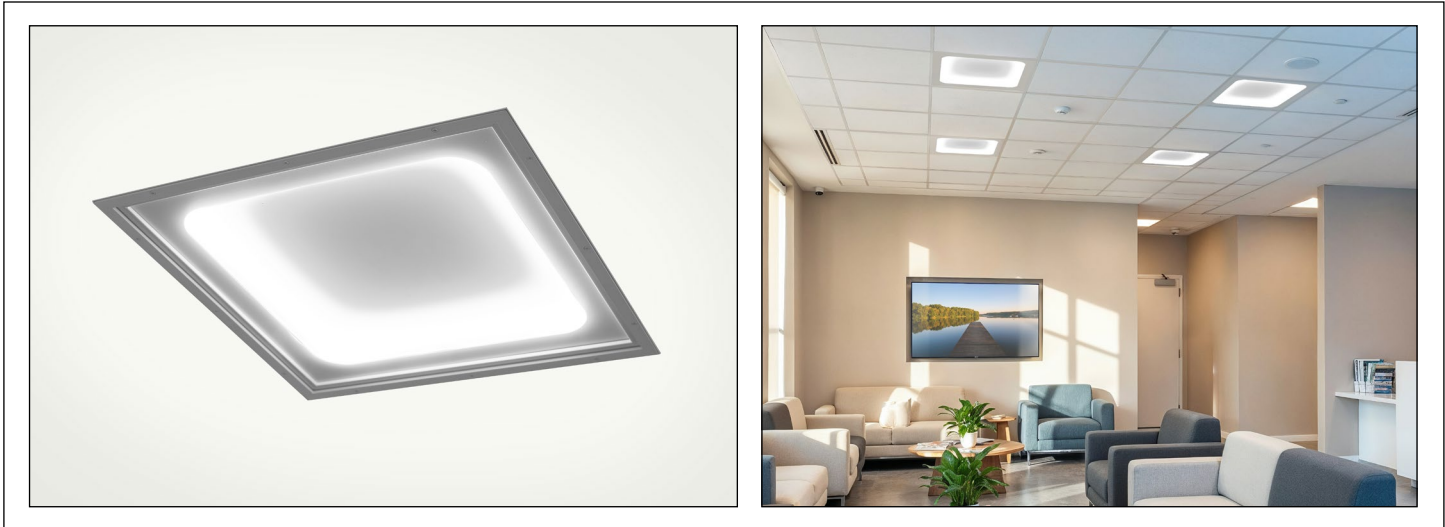

[VisaLighting.com/products/Harmony](https://VisaLighting.com/products/Harmony)

Type: \_\_\_\_\_ Project: \_\_\_\_\_ Location: \_\_\_\_\_

**DIMENSIONS**

W = Width      L = Length      WT = Weight

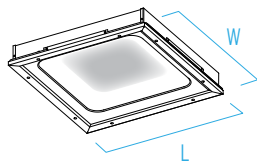
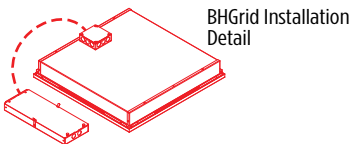
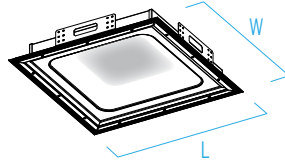
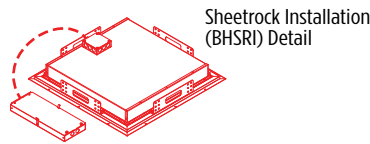
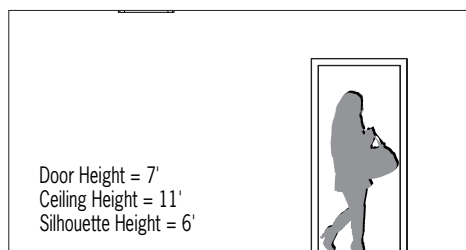
	Grid Install	SRI Install
<b>W</b>	23-3/4" (603 mm)	27-1/2" (700 mm)
<b>L</b>	23-3/4" (603 mm)	27-1/2" (700 mm)
<b>WT (Housing)</b>	22 lbs (9979 gm)	
<b>WT (Driver Box)</b>	< 2.5 lbs (<1134 gm)	

**BHGrid Installation****BHSRI Installation****BHGrid Installation Detail****Sheetrock Installation (BHSRI) Detail****RELATIVE SCALE DRAWING****FEATURES**

- BAA (Buy American Act) and BABA (Build American, Buy America) compliant
- High, medium and low lumen output options
- Impact tests performed exceed IK10+ rating over multiple impacts and include ligature resistance testing after each impact
- High abuse lens and frame features 3/16" thick, high impact clear polycarbonate with anti-scratch coating secured with tamper resistant fasteners
- Ligature resistant; sheetrock/drywall installation (see [Installation Instructions](#)), not suited for grid ceiling installation
- Driver mounted in a separate enclosure; must be remote mounted (connection to fixture by others)
- Diffuser: one piece vacuum formed high transmittance matte white acrylic
- Housing: 14-gauge aluminum body coated in high-reflectance white paint
- Front Bezel: one piece 14-gauge aluminum powder coated in matte white
- Finish: all powder-coated surfaces utilize antimicrobial paint (no VOC)
- Room side of unit is Certified IP65, BHSRI(IP65) installation option only
- Suitable for restricted air flow applications. See [Installation Instructions](#) for more information
- ETL listed for damp locations. Not suitable for exterior applications

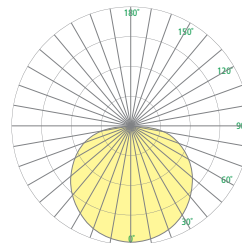
**PHOTOMETRICS**

Compliant



IP65 Certified



ETL Listed



5 Year Warranty

# CM1884-W HARMONY (cont.)

## 2' x 2' Behavioral & Mental Health, General Use



EXAMPLE: CM1884-W-L35K(H)-MVOLT-90CRI-BHSRI

CM1884-W				
MODEL	SOURCE <sup>1</sup>	CIRCUITS-VOLTAGE	INSTALLATION	OPTION
CM1884-W	<b>L30K(H)</b> <b>L30K(M)</b> <b>L30K(L)</b> <b>L35K(H)</b> <b>L35K(M)</b> <b>L35K(L)</b> <b>L40K(H)</b> <b>L40K(M)</b> <b>L40K(L)</b>	<b>MVOLT</b>	<b>BHGRID</b> BH Casing for standard Plenum Ceiling <b>BHSRI</b> BH Casing for Hard Ceiling <b>BHSRI(IP65)</b> BH Casing for Hard Ceiling, IP65	<b>CP</b> Chicago Plenum

SOURCE<sup>1</sup> (Select one)

Dimmable 0-10V to 1%, Minimum 90CRI, within 3-step MacAdam

Source	CCT	Delivered Lumens	Power (Watts)
<b>L30K(H)</b>	3000K	3500	52
<b>L30K(M)</b>	3000K	2600	38
<b>L30K(L)</b>	3000K	1700	25
<b>L35K(H)</b>	3500K	3600	52
<b>L35K(M)</b>	3500K	2700	38
<b>L35K(L)</b>	3500K	1800	25
<b>L40K(H)</b>	4000K	3600	52
<b>L40K(M)</b>	4000K	2700	38
<b>L40K(L)</b>	4000K	1800	25

### LUMEN MAINTENANCE RATING

<b>L85 (reported)</b>	>60,000 hrs
-----------------------	-------------

Reported Lifetime per IES TM-21

# CM1884-W HARMONY (cont.)

2' x 2' Behavioral & Mental Health, General Use

US Patent D1,065,646

## REMOTE DRIVER

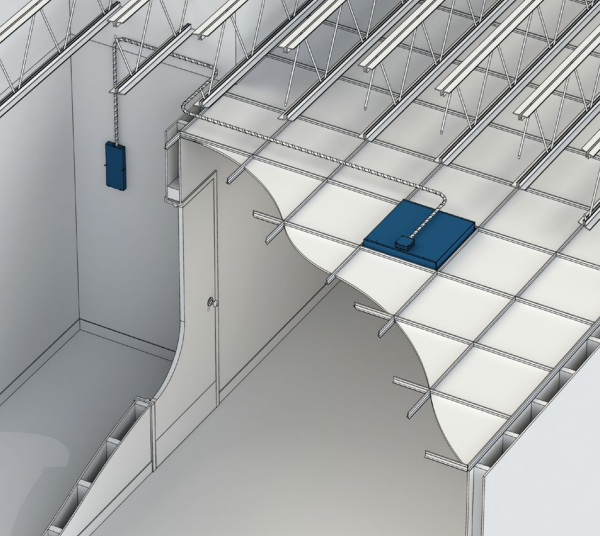

The slim Remote Driver compartment must be mounted in remote locations such as corridors and wiring closets on the floor or wing of the facility using low voltage wiring.

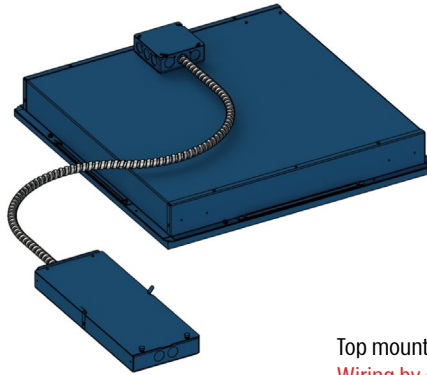

Maximum Recommended  
Remote Wiring  
Distance from Remote  
Driver to Fixture Connection

	2C	3C
10AWG	375 ft	325 ft
12AWG	250 ft	200 ft
14AWG	150 ft	125 ft
16AWG	75 ft	75 ft
18AWG	50 ft	50 ft
20AWG	25 ft	25 ft

Top mounted 4x4 J-box included with remote driver  
Wiring by others

## REMOTE DRIVER BOX INFORMATION

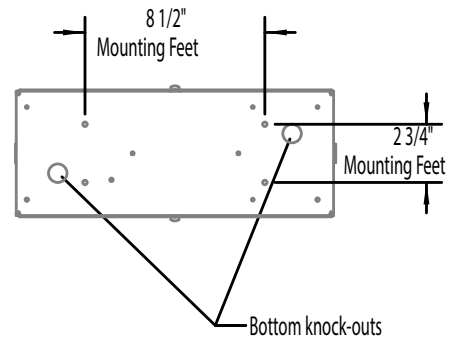
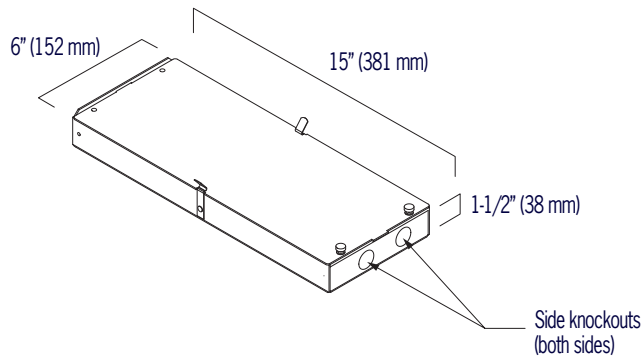

# CM1884-W HARMONY (cont.)

## 2' x 2' Behavioral & Mental Health, General Use

### INSTALLATION INFORMATION

Grid Installation BHGrid Detail

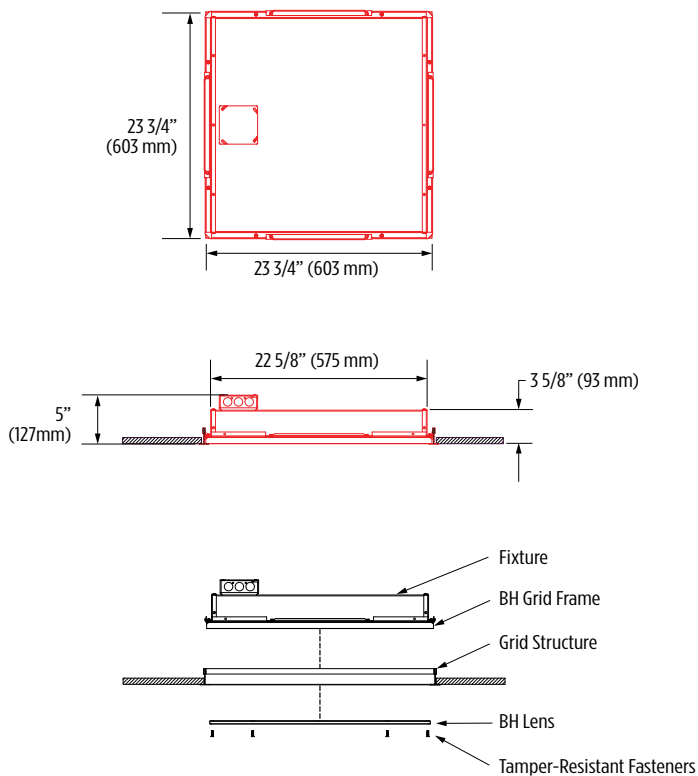

Sheetrock Installation BHSRI & BHSRI(IP65) Detail

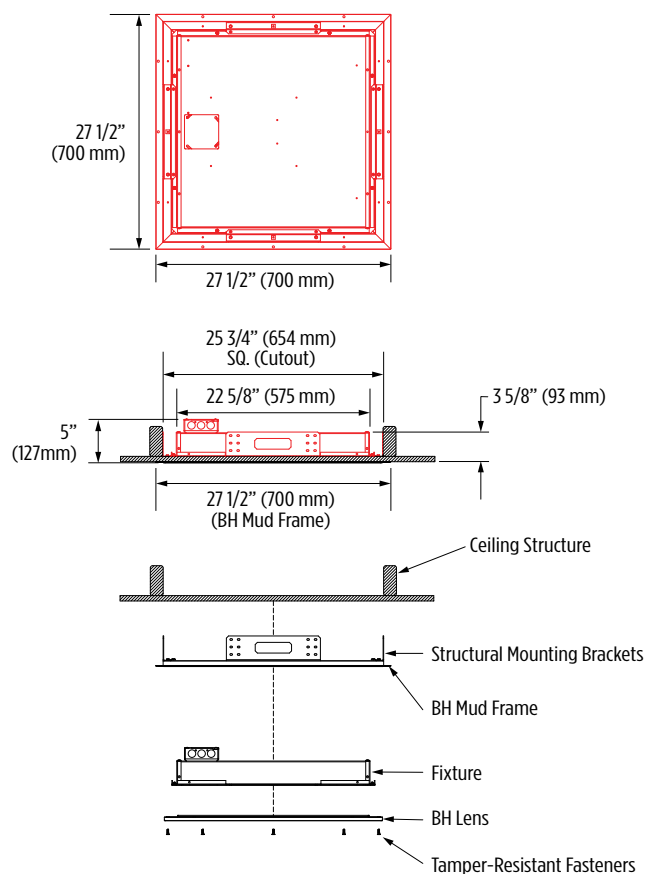

### HARMONY PRODUCT FAMILY

General Use	2'x2'	• CM1882-W
	2'x4'	• CM1886-W
General Use Tunable	2'x2'	• CM1882-T
	2'x4'	• CM1886-T
Overbed	2'x2'	• CM1881-W
	2'x4'	• CM1885-W
High Abuse/ Behavioral Health Overbed	2'x2'	• CM1883-W
	2'x4'	• CM1887-W
High Abuse/ Behavioral Health General Use	2'x2'	• CM1884-W
	2'x4'	• CM1888-W
High Abuse/ Behavioral Health General Use Tunable	2'x2'	• CM1884-T
	2'x4'	• CM1888-T

### SUGGESTED VARIATIONS

- Alternate dimming control compatibility
- Custom colors for lens frame
- Custom light output

See [VisaLighting.com/products/Harmony](https://visalighting.com/products/Harmony) for more information